

SUBARU
1988

	Page
COMPONENT PARTS	2
SERVICE PROCEDURE	4
Instrument Panel	4
Pocket	5

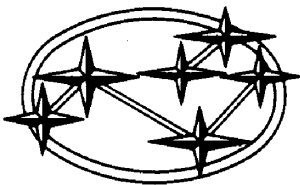

COMPONENT PARTS

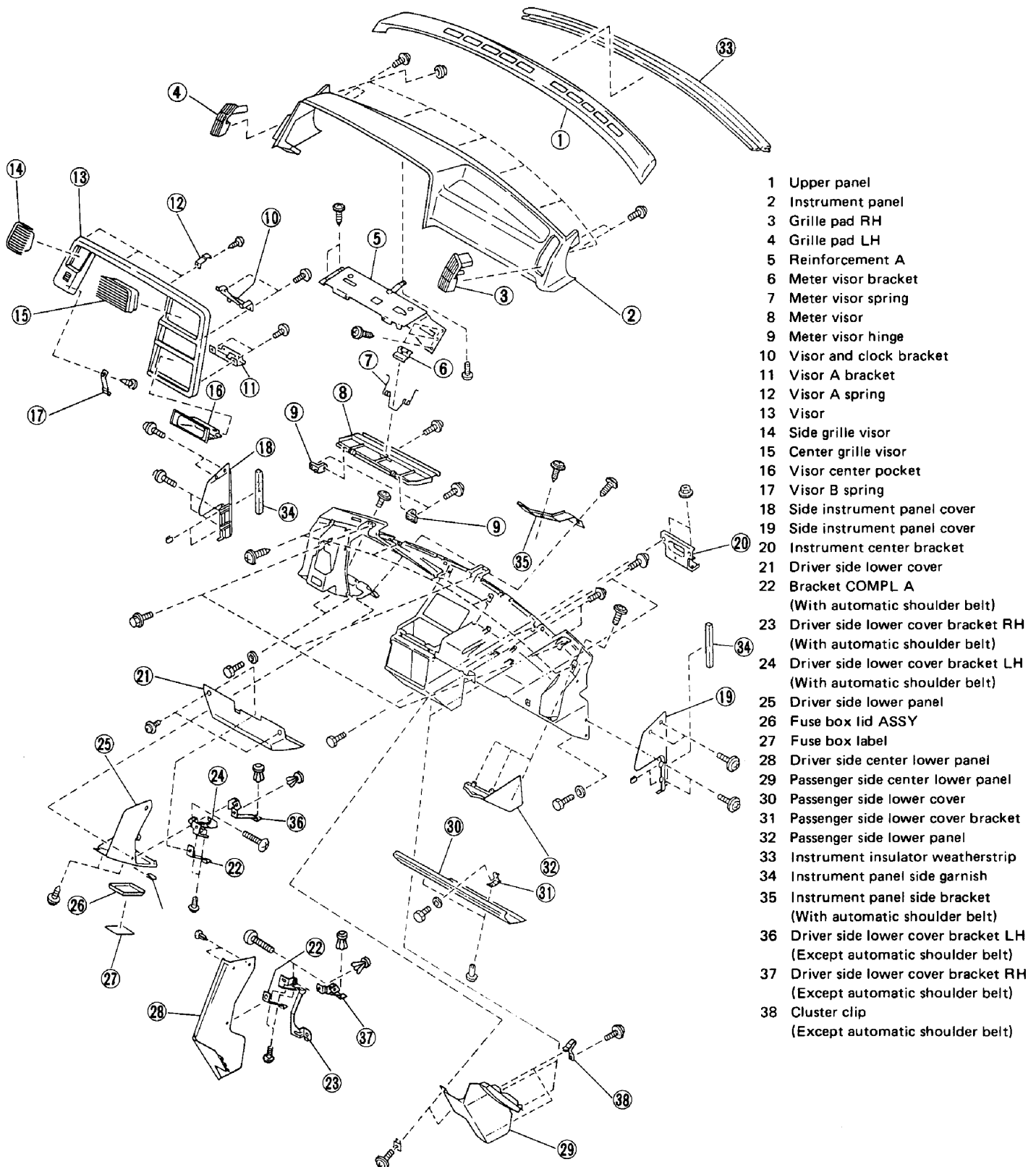

Fig. 1

L5-730

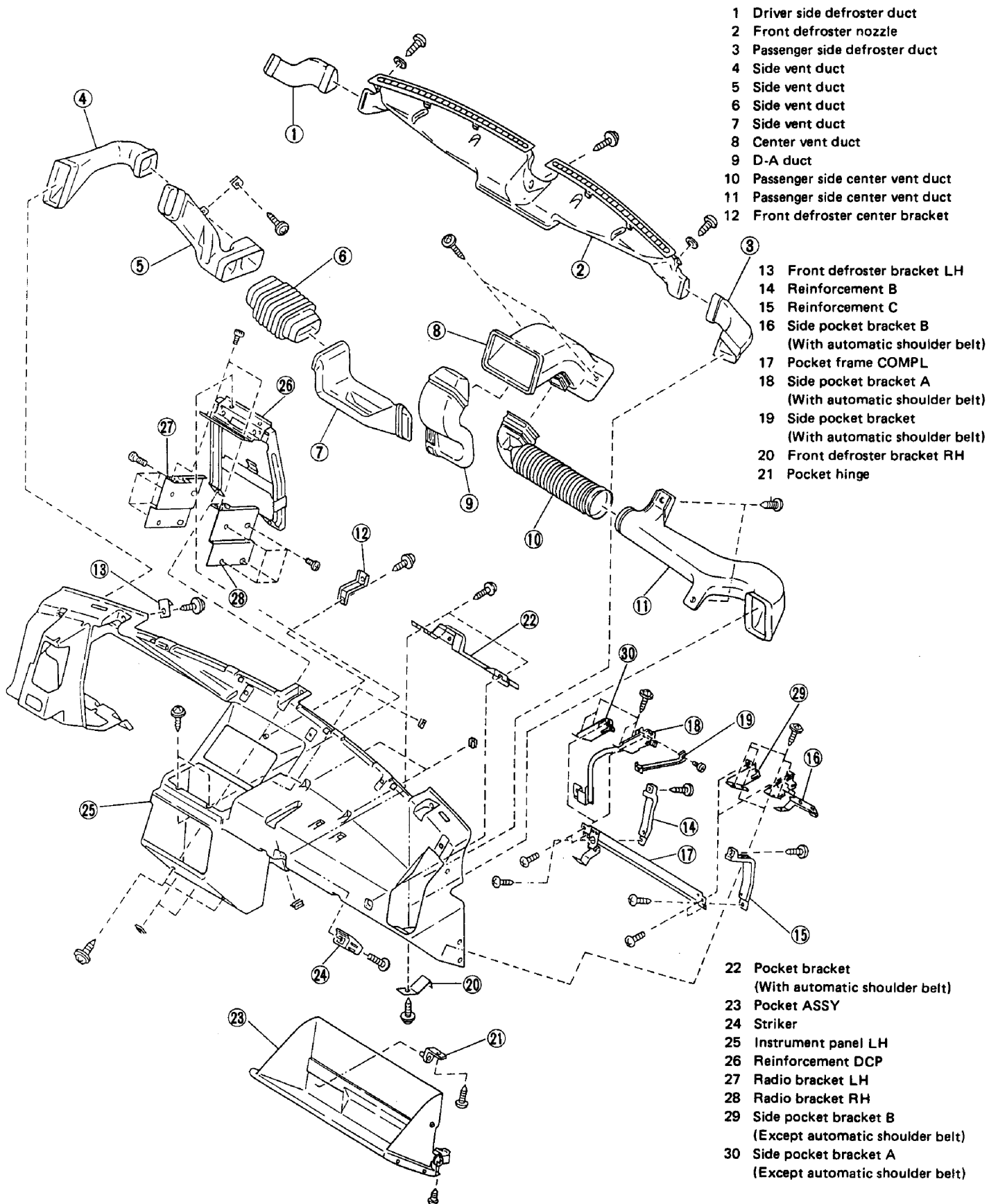

Fig. 2

L5-731

SERVICE PROCEDURE

Instrument Panel

REMOVAL

- 1) Remove lower cover on driver's side.

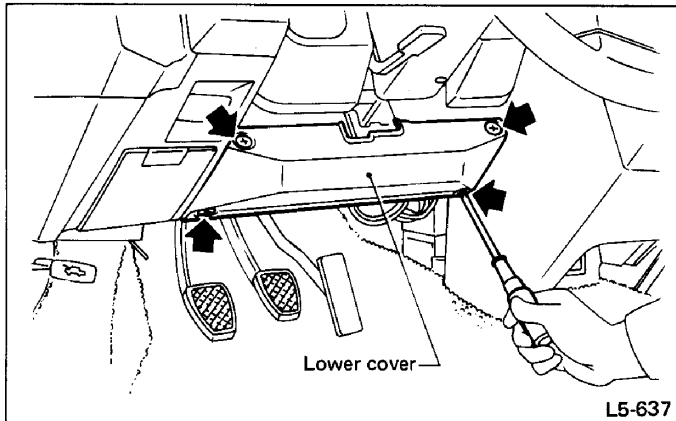

Fig. 3

- 2) Remove side ventilation duct.

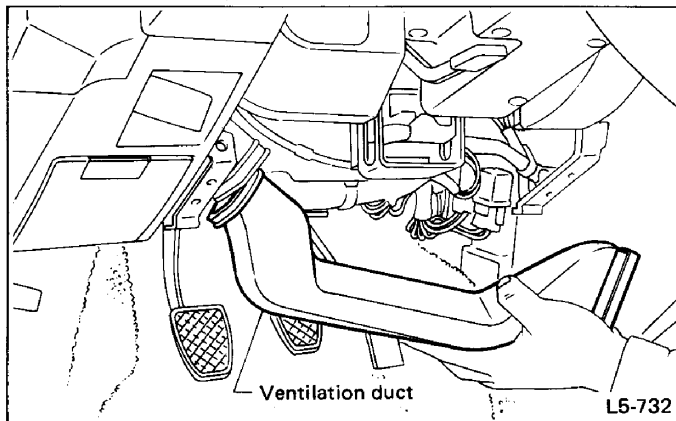

Fig. 4

- 3) Open fuse box lid. Remove screws which hold fuse box, and detach fuse box from instrument panel.

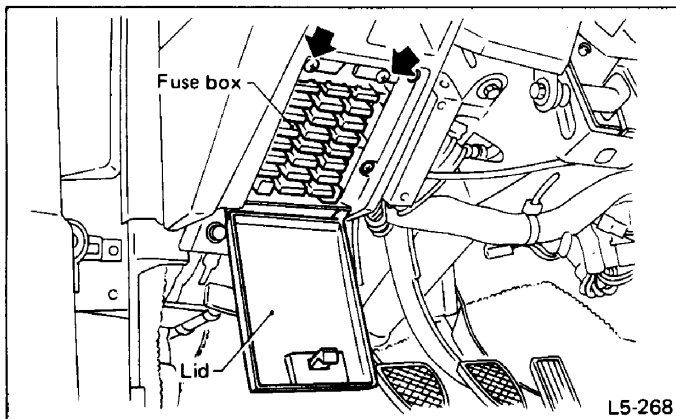

Fig. 5

- 4) Remove lower cover on passenger's side.

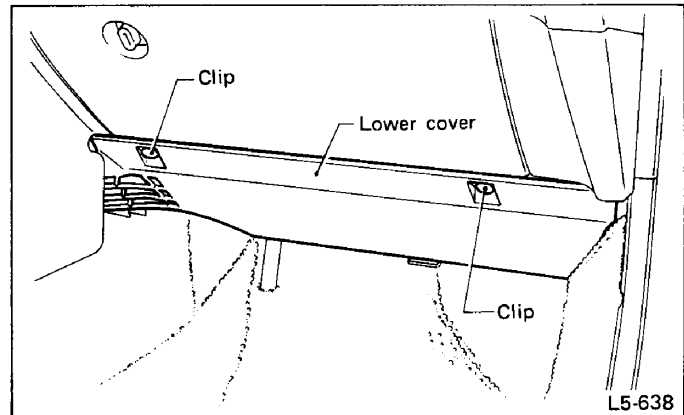

Fig. 6

- 5) Remove instrument panel upper cover by prying it with a standard screwdriver at three points (both sides and middle section).

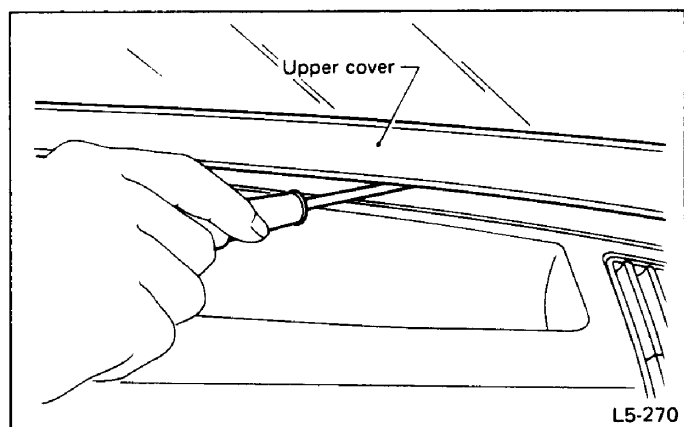

Fig. 7

- 6) Remove console box.

- 7) Remove steering shaft ASSY, combination meter and control wing as a unit.

- 8) Disconnect harness connectors from radio and other parts.

- 9) Remove eight bolts which hold instrument panel, and detach instrument panel.

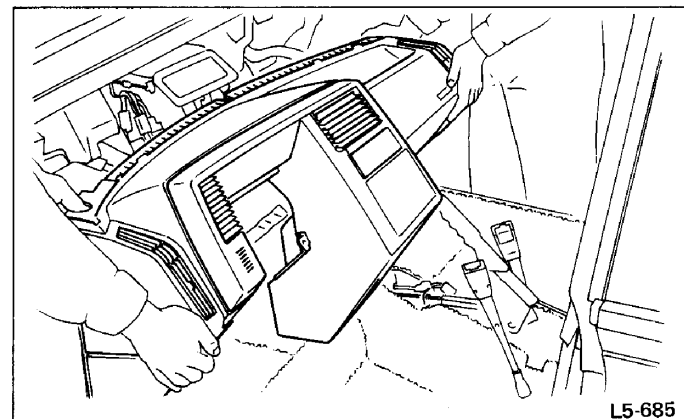

Fig. 8

INSTALLATION

Installation is in the reverse order of removal.

Observe the following:

- 1) Two persons should install instrument panel in vehicle. Be careful not to strike it against adjacent parts during installation.
- 2) While setting instrument panel in position, be careful not to obstruct air outlets of heater and blower with harness connectors.

Also, do not allow them to be caught between bracket and instrument panel.

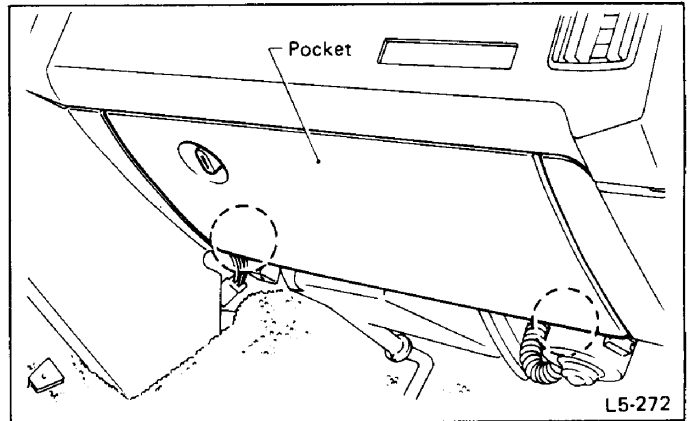

Fig. 9

Pocket**REMOVAL**

- 1) Remove lower cover on passenger's side.
- 2) Remove screws which hold hinge located at the lower section of pocket.

- 3) Disengage lock from striker, remove pocket from instrument panel.

INSTALLATION

Installation is in the reverse order of removal.